

| ITEM | QTY. | DESCRIPTION | PART NUMBER | | | | | BP | BN | BV | FB | PR | RN | RB | DP |
|------|------|-------------------------------|-------------|--------|--------|--------|--------|----|----|----|----|----|----|----|----|
| | | | 1 inch | 2 inch | 3 inch | 4 inch | 6 inch | | | | | | | | |
| 1 | 1 | Washer | 4543 | | 4491 | | | X | X | X | X | X | X | X | X |
| 2 | 1 | Thread Seal | 4542 | | 4488 | | | X | X | X | X | X | X | X | X |
| 3 | 1 | O-Ring | | | 155 | | | X | X | X | X | X | X | X | X |
| 4 | 6 | Filter Screen | | | 619 | | | X | X | X | X | X | X | X | X |
| 5 | 1 | Pilot Plug | 3017 | | 112 | | | X | X | X | X | X | X | X | X |
| 6 | 1 | Gasket Pilot Seat | 3018 | | 118 | | | X | X | X | X | X | X | X | X |
| 7 | 1 | Pilot Seat | 3016 | | 113 | | | X | X | X | X | X | X | X | X |
| 8 | 1 | Diaphragm Stabilizing | 3014 | | 110 | | | X | X | X | X | X | X | X | X |
| 9 | 1 | Pilot Seat | 3015 | | 565 | | | X | X | X | X | X | X | X | X |
| 10 | 1 | Spacer Ring | ----- | | 7437 | | | X | X | X | X | X | X | X | X |
| 11 | 1 | Diaphragm | 3011P | | 5259P | | | X | X | | X | X | X | X | X |
| 12 | 1 | Spring Helical Conical | 3008 | | 108 | | | X | | X | X | X | | X | X |
| | 1 | Spring | 3008 | | 585 | | | | X | | | | | X | |
| 13 | 1 | Diaphragm Stabilizing | 3014 | | 6520 | | | | | | | | | X | |
| 14 | 1 | Gasket Bonnet | 4554 | | 276 | | | | | | | | | X | |
| 15 | 1 | Spring Booster (Ductile only) | ----- | | 566 | | | | | X | | | | | |
| 16 | 1 | Diaphragm (Ductile only) | 3011P | | 688 | | | | | X | | | | | |
| 17 | 1 | Diaphragm | 127 | 1706 | 1640 | 2015 | 2140 | X | X | X | X | X | X | X | X |
| 18 | 1 | Gasket Body | 195 | 196 | 197 | 198 | 199 | X | X | X | X | X | X | X | X |
| 19 | 2 | Back Up | 148T | 149T | 150T | 151T | 152T | X | X | | X | X | X | X | X |
| 20 | 1 | O-Ring | 153 | 154 | 155 | 156 | 157 | X | X | | X | X | X | X | X |
| 21 | 1 | Seat Full Port | 163 | 164 | 165 | 166 | 167 | X | X | X | X | X | X | X | X |
| | | Seat Reduced Port | 163 | 164 | 1230 | 164 | 165 | X | X | X | X | X | X | X | X |
| 22 | 1 | Gasket Removable Seat | ----- | 276 | 277 | 196 | 279 | X | X | X | X | X | X | X | X |
| 23 | 1 | Nut Full Port | 172 | 173 | 906 | 175 | X | X | X | X | X | X | X | X | X |
| | | Nut Reduced Port | 172 | 173 | 173 | 906 | X | X | X | X | X | X | X | X | X |
| 24 | 1 | O-Ring (Steel only) | ----- | 5225 | 5226 | 5227 | 4086 | X | X | X | X | X | X | X | X |

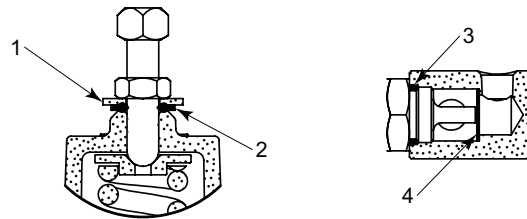

BP, BN, DP

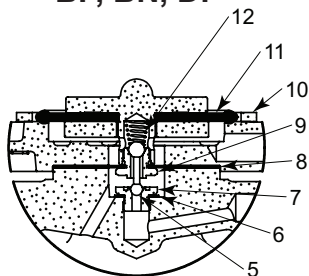

PR, RN, FB

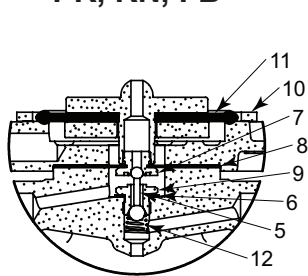

RB

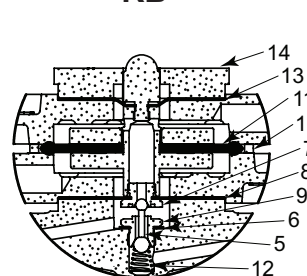

BV

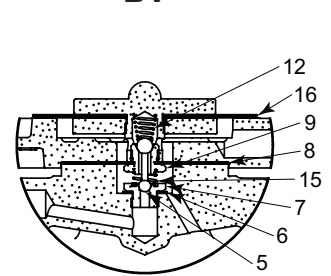

Please note the Pilot Plug (7) and Spring (12) orientation

Ductile

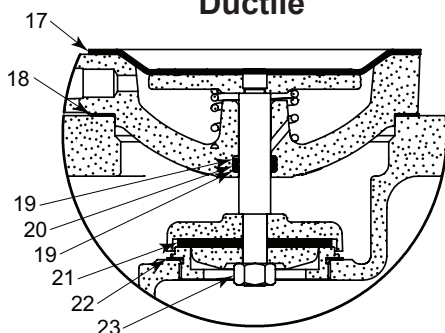

Steel

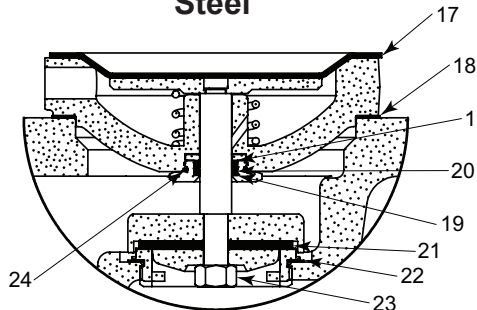

Scan here for Spec Sheet

All Pictures shown are for illustration purpose only. Actual product may vary due to product enhancement.

For additional information & documentation visit www.kimray.com

PRESSURE REGULATORS



**REPAIR KIT
6 INCH STANDARD PRESSURE REGULATORS**

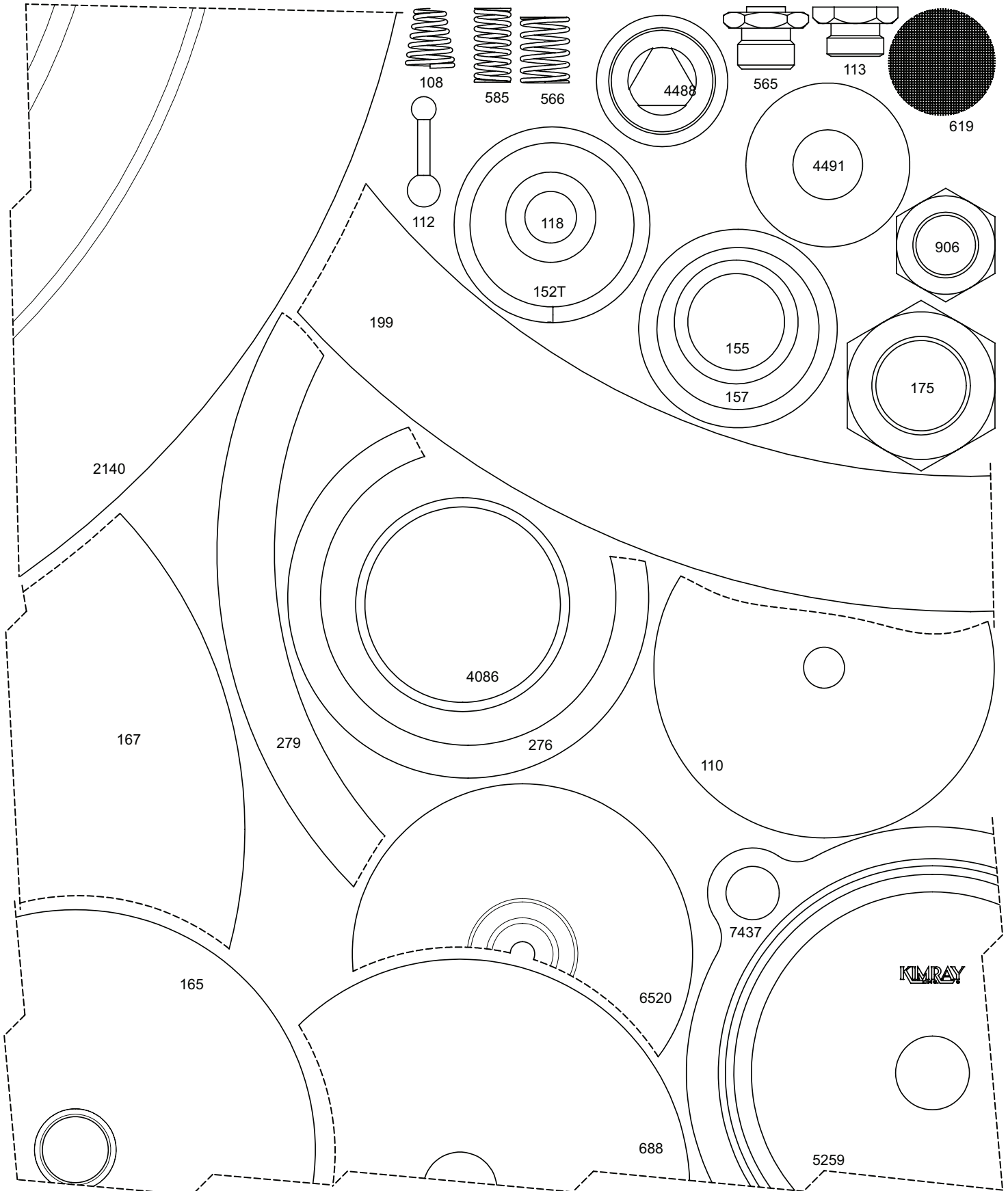

All Pictures shown are for illustration purpose only. Actual product may vary due to product enhancement.